

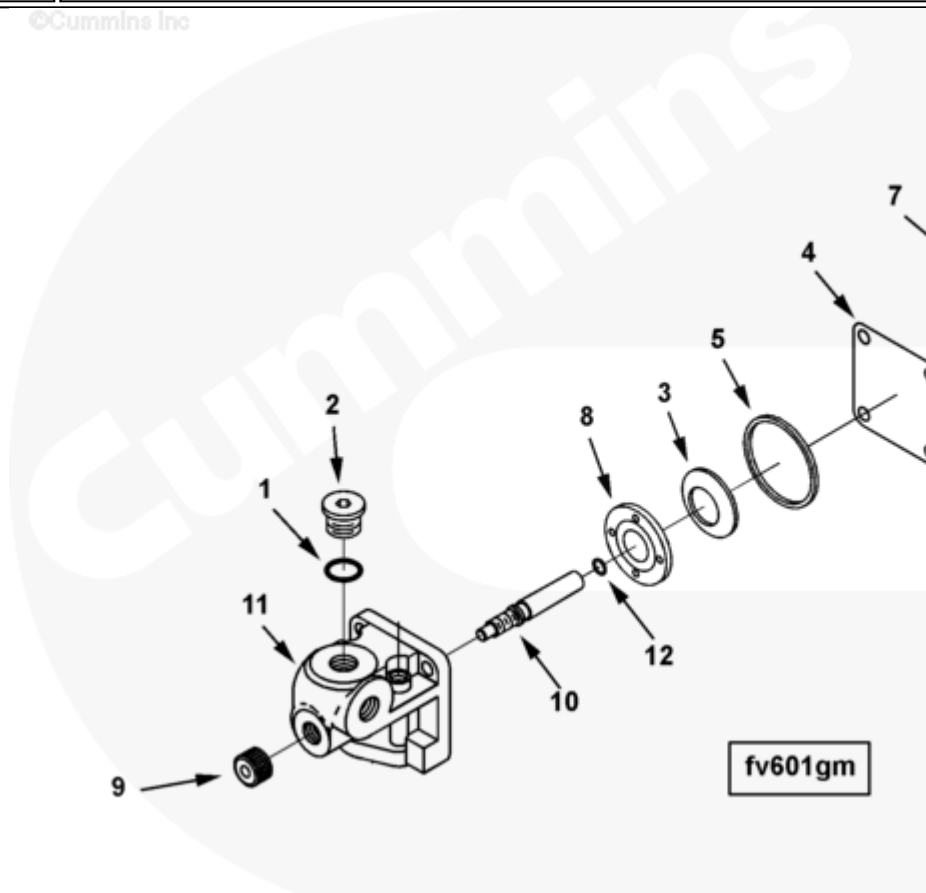

Parts Catalog - Option Detail

| Electronic Parts Catalog - Option Detail | | | | |
|--|---|---------|-----------|-----------|
| Option | Group | Graphic | Film Card | Date |
| FV6028-02 | 05.06 | fv601gm | K38 | 27-JUN-98 |
| Engines | GTA38, K38, KTA38GC CM558, QSK38 CM2150 K106, QSK38 CM2150 MCRS, QSK38 CM850 MCRS | | | |

©Cummins Inc



[SMALL](#) | [MEDIUM](#) | [LARGE](#)

| Cart | Ref No | Part Number | Part Description | Required | Remarks |
|--------------|--------|---------------------------|------------------|----------|--|
| View My Cart | | | | | |
| | | FV6028-02 | Fuel Valve | | Fuel shut off valve...(More) |
| | | | | | type: Standard |
| | | | | | Voltage: 24volt DC Heavy |
| | | | | | Duty - Standard terminals: |
| | | | | | Twin terminal (insulated |
| | | | | | ground) manual override: Yes. |

| | | | | | |
|--------------------------|----|-------------------------|--------------------------|---|----------------|
| <input type="checkbox"/> | | 3348327 | Shut-Off Valve | 1 | |
| <input type="checkbox"/> | | 3067424 | Threaded Plug | 1 | 1/2 - 20 UNF. |
| <input type="checkbox"/> | 1 | 3037236 | O-Ring Seal | 1 | Ref. SPT 97T10 |
| | 2 | 3067347 | Threaded Plug | 1 | |
| | | 3348326 | Fuel Shut-Off Valve | 1 | |
| <input type="checkbox"/> | 3 | 129768 | Valve Spring | 1 | |
| <input type="checkbox"/> | 4 | 129839 | Shut-Off Valve Shield | 1 | |
| <input type="checkbox"/> | 5 | 129888 | Rectangular Ring Seal | 1 | |
| <input type="checkbox"/> | 6 | 187556 | Fillister Head Cap Screw | 4 | |
| <input type="checkbox"/> | 7 | 3021420 | Solenoid | 1 | |
| <input type="checkbox"/> | 8 | 3030970 | Valve Disc | 1 | |
| <input type="checkbox"/> | | 3073890 | Fuel Shut-Off Valve Body | 1 | |
| <input type="checkbox"/> | 9 | 129838 | Knob | 1 | |
| <input type="checkbox"/> | 10 | 3013036 | Shut-Off Valve Shaft | 1 | |
| | 11 | 3073891 | Shut-Off Valve Body | 1 | |
| <input type="checkbox"/> | 12 | 3279794 | O-Ring Seal | 1 | |